

*Sunshine Blade*  
**Instant**  
**Heater**

**Owner's Manual**



***CARBON INFRARED HEATER***  
***Radiant Heat, just like the Sun***

*Sunshine Blade*  
**Instant**  
**Heater**

Congratulations on purchasing the Sunshine Blade Instant Heat.  
Before using it, please read this owner's manual carefully, and keep  
it somewhere safe for future reference.



[www.instantheater.co.uk](http://www.instantheater.co.uk)

## SAFETY INSTRUCTIONS

When using electrical appliances, basic safety precautions should always be followed to reduce the risk of fire, electric shock and injury to persons, including the following:



**WARNING: FIRE RISK EXISTS IF THE HEATER IS COVERED BY OR POSITIONED CLOSE TO CURTAINS OR OTHER COMBUSTIBLE MATERIALS.**

### WARNINGS:

- Children of less than 3 years should be kept away unless continuously supervised.
- Children aged from 3 years and less than 8 years shall only switch on/off the appliance provided that it has been placed or installed in its intended normal operating position and they have been given supervision or instruction concerning use of the appliance in a safe way and understand the hazards involved. Children aged from 3 years and less than 8 years shall not plug in, regulate and clean the appliance or perform user maintenance.
- CAUTION — Some parts of this product can become very hot and cause burns. Particular attention has to be given where children and vulnerable people are present.
- WARNING: In order to avoid overheating, do not cover the heater.
- If the supply cord is damaged, it must be replaced by the manufacturer, its service agent or similarly qualified persons in order to avoid a hazard.
- This heater is not equipped with a device to control the room temperature.
- Do not use this heater in small rooms when they are occupied by persons not capable of leaving the room on their own, unless constant supervision is provided.
- Read all instructions before installing and using this heater.
- The heater must be installed at least 1.8m (6ft) above the floor.
- This heater is designed for use on a 220-240V AC supply only.
- Use this heater only as described in this manual. Any other use not recommended by the manufacturer may cause fire, electric shock, or injury to persons.
- This appliance is not intended for use by persons (including children) with reduced physical, sensory or mental capabilities, or lack of experience and knowledge, unless they have been given supervision or instruction concerning use of the appliance by a person responsible for their safety.
- Children should be supervised to ensure they do not play with the appliance.
- The fireguard of this heater is intended to prevent direct access to heating elements and must be in place when the heater is in use.
- The fireguard does not give full protection for young children and infirm persons.
- This heater must be earthed. Connect to properly grounded outlets only.
- Ensure both plug and socket is clean and free from dust when using.
- To disconnect the heater from the power supply, turn off the heater, switch off the power point, grip the plug and pull from the power socket.
- Never pull by the cord.
- Never touch the plug with wet or moist hands.
- Do not use an extension cord with this heater.
- Regularly inspect the power cord and plug for wear or damage and do not operate the heater with a damaged cord, plug or loose socket or after the heater malfunctions, or has been dropped or damaged in any manner.
- Do not use the heater if the heating element is cracked or broken.

## WARNINGS:

- The heater must not be located immediately below or in front of a socket outlet or connection box.
- Keep combustible materials such as furniture, pillows, bedding, paper, clothes and curtains at least 1.5m from the front of the heater and keep them away from the sides and rear.
- Do not allow the supply cord to sit or hang in front of the heater while in use.
- Do not use the heater in areas where gasoline, paint, flammable liquids or highly combustible dusts are used or stored.
- If this heater is to be used in bathroom, it is to be installed so that switches and other controls cannot be touched by a person in the bath or shower.
- Never locate heater where it may fall into a bathtub or other water container.
- Extreme care should be taken whenever the heater is left operating and unattended.
- Never use the heater while sleeping.
- Do not cover the heater.
- Do not insert any object into the heater.
- Never touch the heater while in use.
- Always disconnect the heater from the electricity supply and allow it to cool before adjusting the position or attempting to work on it.
- The heater is in stand-by mode when plugged in and can be turned on by the remote. When not in use, remove the plug from the wall socket outlet to completely turn off the heater.
- When used outdoors, always use a weatherproof power outlet and a residual current device (RCD).
- The Sunshine Blade Instant Heat is protected from rain sprays. Do not direct water at the heater, e.g. splashing or from a garden hose.

## IMPORTANT:

**The support tabs holding the heating element must be removed before use. Any damage caused by leaving these tabs in and using the heater is not covered under warranty and will incur a refurbishment fee to cover the cost of new parts and a servicing charge.**



**When returning a Sunshine Blade Heater, it must be returned in its original packaging, including all packaging inserts. If a returned heater is damaged in transit and does not have the correct packaging, the customer will be held responsible for the damage and be required to pay a refurbishment fee to cover the cost of new parts and a servicing charge.**

## INTRODUCTION

Your Sunshine Blade is a robust and weatherproof heater, ideal for both indoor and outdoor use. Requiring no time to heat up, it provides comfortable heat instantly.

That's because the Sunshine Blade carbon infrared lamp produces instant radiant heat, just like the sun. Unlike conventional convection heating, the Sunshine Blade doesn't heat the air. Rather, it transfers radiant heat from the Sunshine Blade lamp to an object, just like the warmth of the sun heating a rock, or the feeling of sunshine on your face.

## INDOORS

Used indoors, your Sunshine Blade will only warm you and objects in the room, such as carpets or furniture. It won't heat and dry out the air.



## OUTDOORS

In an outdoor environment, the surrounding air is constantly moving. This makes convection heating impractical because once the air is heated, it just blows away – leaving you without the warmth you desire. But the Sunshine Blade enables you to target outdoor areas, warming only the people and objects in the heater's path, for maximum warmth and maximum efficiency.

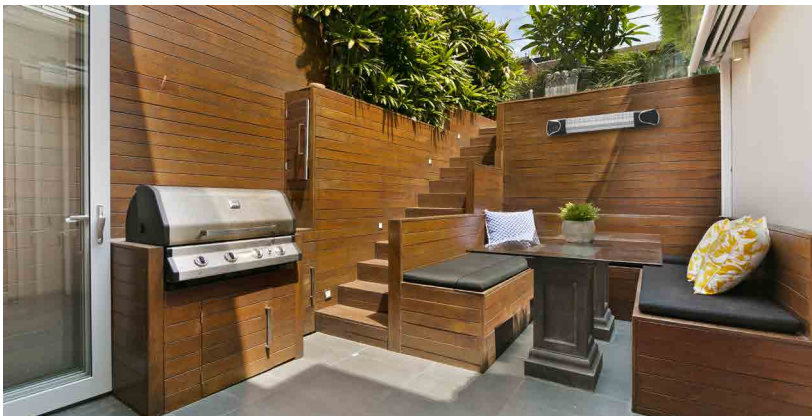

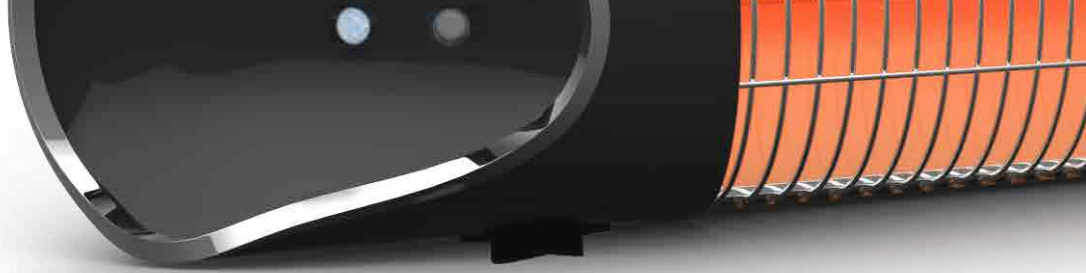

## WALL MOUNTING INSTALLATION

- The Sunshine Blade must be mounted horizontally only. If using the standard plug, an electrician is not required for installation. A qualified electrician is only required if the Instant Heater is being hard wired into the wall.
- **DO NOT** install the heater on an inflammable surface.
- The lowest part of the heater must be located at or above a minimum height of 1.8m from ground level, so that the heater cannot be touched when in operation.
- When mounting, do not position the heater at an angle more than 90° and less than 45° (Refer to the installation diagram on the next page)
- **NOTE:** If this angle is exceeded, the heater it will automatically switch off.
- Ensure the orientation is correct. The end with the cord and display panel should be to the left-hand side.
- Keep the power cord away from the body of the heater, as the body will get hot when the heater is in use.
- When mounting the heater, pay attention to the minimum safe distance between the heater body and inflammable surfaces.
- The heater should always have a minimum clearance of 0.3m from a ceiling and adjacent walls.
- When used outdoors, always use a weatherproof power outlet and a residual current device (RCD).
- Before drilling mounting holes, make sure there are no wires or water pipes behind the wall or ceiling onto which the heater is to be mounted.
- The heater must be installed using the mounting brackets provided.
- Fasten the brackets securely to the mounting surface and the back of the heater using the nuts and bolts supplied.
- Fasten the heater securely onto the brackets using the nuts and bolts supplied.
- The brackets can be used to adjust the direction of the heater. Adjust the heater angle by loosening the two bolts on the wall.

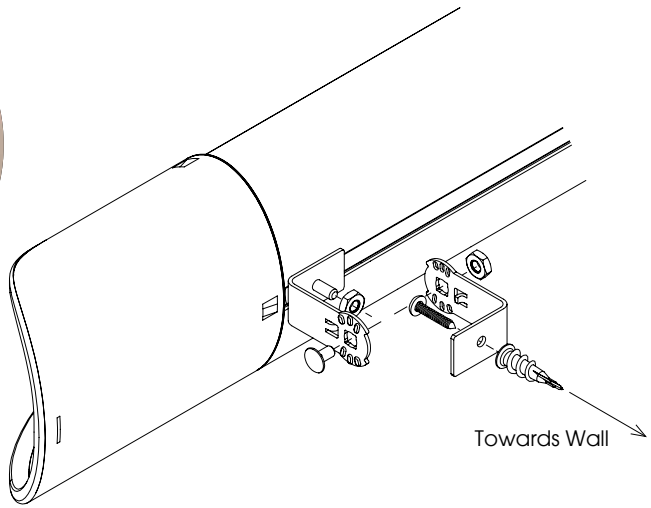
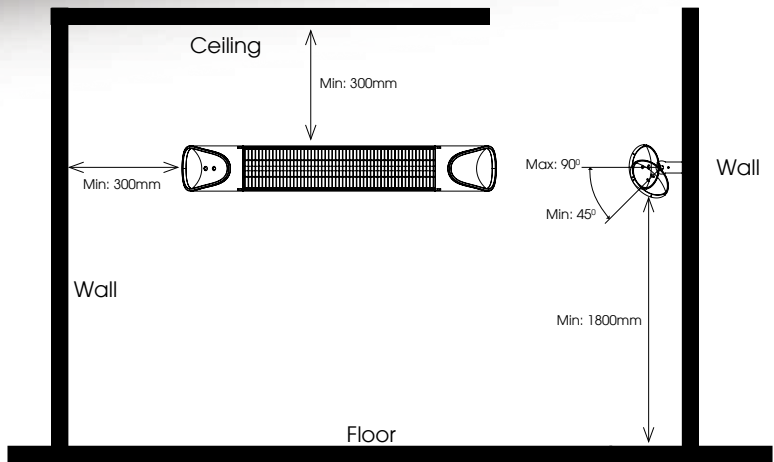

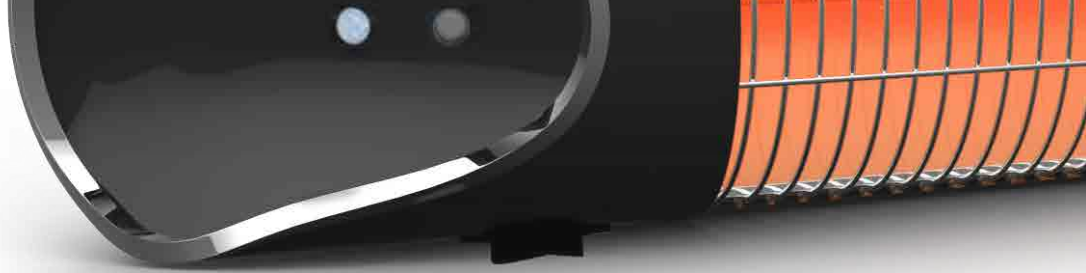

## PARTS & ASSEMBLY

(drawings not to scale)

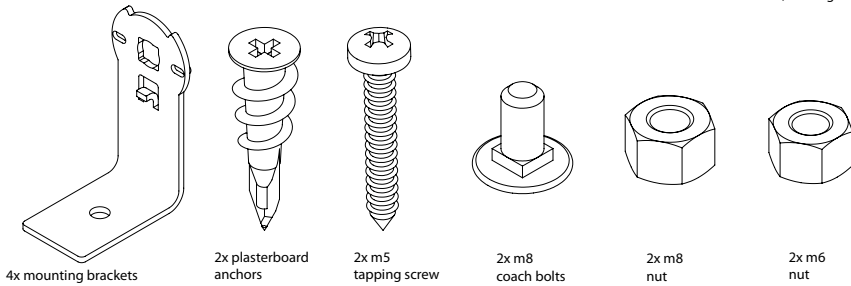

## WALL MOUNTING

1. Measure & secure 2 mounting brackets on a wall 530mm horizontally apart, measured from the hole centres. Ensure you use the correct wall anchors for your wall, plasterboard anchors are supplied.

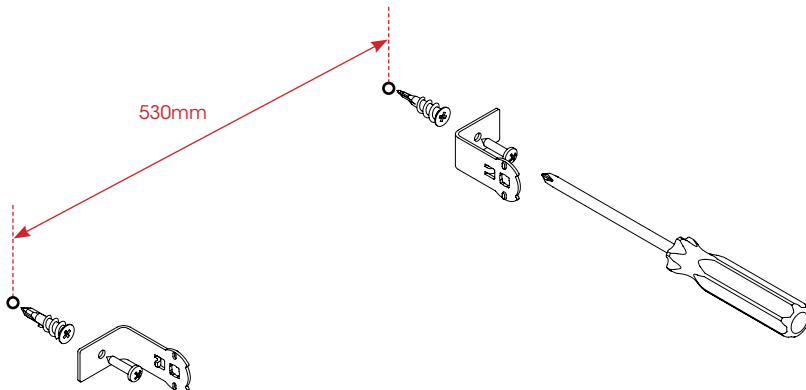





2. Secure the remaining 2 mounting brackets to the back of the heater with the supplied M6 nuts, tightening loosely.

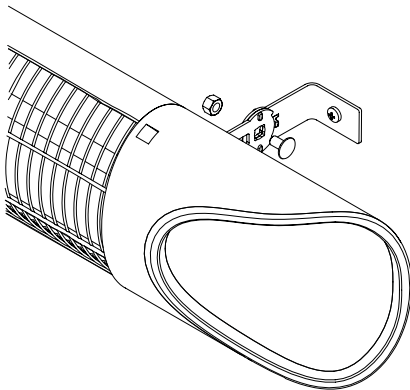
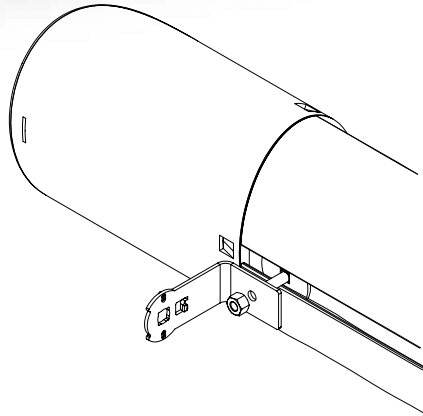

3. Lift the heater up to the wall mounted brackets. Bolt the brackets together loosely using the supplied M8 coach bolts and nuts.

4. Adjust the heater to the desired angle, then tighten all nuts once in the desired position.

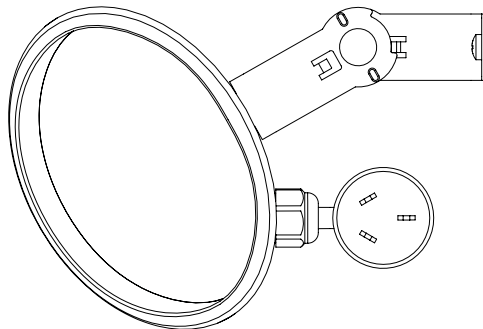



## HEATER OPERATION

- To turn the heater on, switch the power switch on at the bottom of the unit, the display will show '0'
- To change heat settings, press the level button on the front of the unit and choose between settings 1-4, or use the remote by pressing the level button on the remote and using the up or down arrow button to change between levels.
- Press the timer button then set the sleep timer by pressing the arrows buttons
- To go back to stand-by mode, press the stand-by button on the remote
- Press the sensor button on the remote to set to the motion sensor mode. While in this mode, when motion is detected, the heater will stay on for 15 minutes. If no motion is detected during this 15-minute period, the heating element will turn off (during this mode, the display will show A-). If no motion is detected within 1 hour of this state, the heater will revert to the normal standby mode (need to press stand-by button to turn on heater, and no longer be in motion sensor mode).
- To activate motion sensor mode again, press the sensor button on the remote.
- To turn off unit, switch the power button off at the bottom of the unit.



Battery Compartment





## REPLACING THE BATTERY

- Press the battery compartment release button and then slide out the battery tray.
- Remove the old battery and put the new battery in, making sure that the battery's positive side is facing up. Use only a CR2025 or CR2032 battery in this remote control.
- Slide the battery tray back into the remote control until it clicks.  
**Note:** Do not allow water or liquid to get into the remote control.

## CLEANING AND MAINTENANCE

- Always disconnect the heater from the power supply and allow it to cool before attempting any maintenance.
- If the heater has collected dust or dirt inside the unit or around the heating element, DO NOT operate the heater in this condition. Always have the unit cleaned by a qualified service agent.
- The only maintenance required by the owner is cleaning of the external surfaces.
- Use a damp cloth to wipe the outside of the heater. DO NOT use powerful abrasive or solvent cleaning fluids when cleaning the heater as they may damage the plastic parts.
- If the heater is to be removed from its mounting position when not in use, always store it carefully in a safe, dry, childproof location.
- Do not touch the heating element with bare fingers, as residue from your hand could affect the life of the lamp. If the lamp is accidentally touched, remove the finger marks with a soft cloth moistened with methylated spirit or alcohol. Always allow the methylated spirit or alcohol to completely evaporate before using the heater.
- Do not attempt to repair or adjust any electrical or mechanical functions on the heater.
- The heater contains no user-serviceable parts. Should the product suffer damage or breakdown, it must be returned to the manufacturer or its service agent.
- Damaged power cords are to be replaced by the manufacturer, service agent or similarly qualified person.

## RECYCLING

At the end of the product's useful life it should not be disposed of with household waste. Please check with your Local Authority or recycling advice in your country. Always recycle where facilities exist.

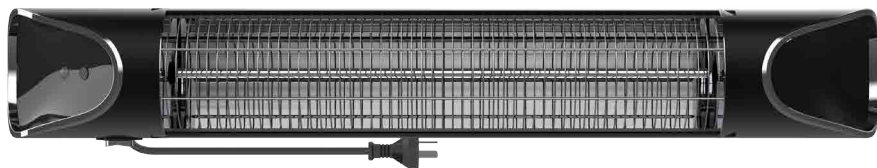

## SPECIFICATIONS

Voltage (V)	220-240V AC , 50 Hz / 60 Hz
Power (W)	2000W
Water Ingress Protection	IPX4
Dimensions W x H x D (mm)	900 x 130 x 90
Weight (kg)	2.6kg
Class	I



Do not dispose of electric appliances in the garbage

According to the European Directive 2012/19/EU, with reference to waste electronic, electrical equipment and tools, and its transposition to the national legislation, end of life electric appliances must be collected separately and taken for environmentally compatible recycling.

Contact your local authority for recycling of used electric appliances.



declaration of conformity:

The manufacturer declares that the product Sunshine Blade Radiant Heater SNBHR\_UK is in compliance with the following standards, normative documents and in accordance with EU directives:

Low Voltage Directive (2014/35/EU)

Electromagnetic Compatibility Directive (2014/30/EU)

ROHS Directive (2011/65/EU)

WEEE Directive (2012/19/EU)

Ecodesign – Standby and off mode Directive (2005/32/EC)

REACH regulation (EC) no. 1907/2006

Applicable harmonised standards:

EN 60335-1: 2012 +A11:2014

EN 60335-2-30: 2009 +A11:2012

EN 62233:2008

IEC 62301: 2011

EN 55014-1: 2006 +A1:2009 +A2:2011

EN 55014-2: 2015

EN 61000-3-2: 2014

EN 61000-3-3: 2013

## **BRAND DEVELOPERS LIMITED WARRANTY FOR SUNSHINE BLADE INSTANT HEAT**

### **YOUR GUARANTEE**

This product is under guarantee for 12 months. We do not accept returns outside the 30-day trial period, but we do respect your statutory rights.

### **LIMITED ONE YEAR WARRANTY**

If the product, or any part of the Product, becomes defective due to faulty materials or workmanship within a period of 1 year from the date of purchase, we warrant to replace the product with a new product, free of charge, or repair the product at our cost, at our discretion.

### **EXCLUSIONS**

Excluded from this limited warranty are damages to the Product caused by unreasonable or unintended use, abuse, neglect, or unauthorised modification or repair. Also excluded is damage from ordinary wear and tear.

### **VOIDING OF LIMITED WARRANTY:**

THE FOLLOWING OCCURRENCES OR CONDITIONS WILL VOID THIS LIMITED WARRANTY: (1) USE FOR COMMERCIAL PURPOSES; (2) FAILURE TO USE THE Product ACCORDING TO THE manufacturer'S SPECIFICATIONS AND INSTRUCTIONS INCLUDING, WITHOUT LIMITATION, SAFETY INSTRUCTIONS AND WARNINGS; (3) FAILURE TO PROPERLY CLEAN AND MAINTAIN THE Product AS STATED IN THE MANUAL; AND (4) TRANSFER OR ASSIGNMENT OF THIS WARRANTY.

### **SOLE REMEDY**

The sole remedy under this limited warranty is repair or replacement, at our discretion, of the Product or part(s) deemed to be defective. "Repair" or "Replacement" shall mean providing the labour and materials necessary, at no cost to the consumer, to repair or replace the defective parts or replace, at our discretion, the Product. Replacement items will be covered by the limited warranty for the balance of the warranty period from the date of the original purchase.

### **HOW TO MAKE A WARRANTY CLAIM:**

To present a claim under this limited warranty, call the telephone number below to receive a return authorisation code.

**UK : 0800 078 6222**

**Ireland : 1800 827 847**

### **DISCLAIMER:**

The Warranty in this document is the only Warranty on the Product. Brand Developers Ltd makes no other Warranty of any kind, express or implied. All implied Warranties of merchantability and fitness for a particular purpose which exceed the obligation or time limits stated in this Warranty are hereby disclaimed by Brand Developers Ltd and excluded from this Warranty.

### **Distributed by:**

Brand Developers Limited

### **Hallmark Consumer Services**

c/o Goods In  
Green Bank,  
Saxby Road,  
Melton Mowbray  
LE13 1FF, UK

### **Customer Care Email**

**customercare@bdl.email**

Table for information requirements for electric local space heaters					P
Model identifier(s):					
Item	Symbol	Value	Unit	Item	Unit
Heat output				Type of heat input, for electric local space heaters only (select one)	
Nominal heat output	P <sub>nom</sub>	2.0	kW	Manual heat charge control with integrated thermostat	[no]
Minimum heat output (indicative)	P <sub>min</sub>	N/A	kW	Manual heat charge control with room and/or outdoor temperature feedback	[no]
Maximum continuous heat output	P <sub>max</sub>	2.0	kW	Electronic heat charge control with room and/or outdoor temperature feedback	[no]
Auxiliary electricity consumption				Fan assisted heat output	[no]
At nominal heat output	e <sub>lmax</sub>	N/A	kW	Type of heat output/room temperature control (select one)	
At minimum heat output	e <sub>lmin</sub>	N/A	kW	Single stage heat output and no room temperature control	[no]
In standby mode	e <sub>lSB</sub>	0.49	W	Two or more manual stages, no room temperature control	[yes]
				With mechanic thermostat room temperature control	[no]
				With electronic room temperature control	[no]
				Electronic room temperature control plus day timer	[no]
				Electronic room temperature control plus week timer	[no]
				Other control options (multiple selections possible)	
				Room temperature control, with presence detection	[yes]
				Room temperature control, with open window detection	[no]
				With distance control option	[no]
				With adaptive start control	[no]
				With working time limitation	[no]
Contact details:	X.J GROUP (HK) LTD 7F, 7Bldg., Shatoujiao Free Trade Zone, Yantian, Shenzhen, China				
Remark: For electric local space heaters, the measured seasonal space heating energy efficiency $\eta_s$ cannot be worse than the declared value at the nominal heat output of the unit.					

*Sunshine Blade*  
**Instant**  
**Heater**



**Distributed by:**  
**Brand Developers Limited**

**Hallmark Consumer Services**  
c/o Goods In  
Green Bank,  
Saxby Road,  
Melton Mowbray  
LE13 1FF, UK

**[www.instantheater.co.uk](http://www.instantheater.co.uk)**